

Jayco | 2024 Eagle HT Fifth Wheel

# EAGLE HT FW

ADVENTURES AROUND EVERY BEND



# INTERIOR DESIGN



## CLASSIC FARMHOUSE



Main Wood



Accent Wood



Floor



Countertop



Main Fabric



Accent Fabric



# EAGLE HT FW

- S** STORAGE
- MICRO** MICROWAVE
- OHC** OVERHEAD CABINETS
- FRIDGE** REFRIGERATOR
- WARD** WARDROBE

## OPTIONS

- A**  
  
Dinette
- B**  
  
Griddle/Sink
- C**  
  
Tri-fold Sofa

**25RUC** OPTION: B

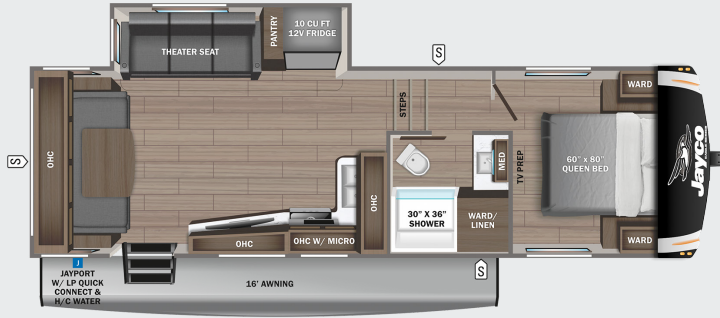

**26REC** OPTIONS: A, B, C

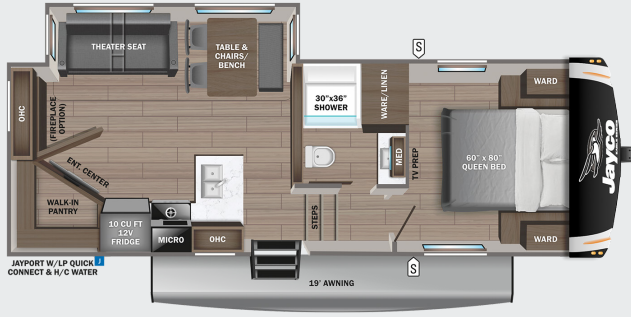

**29DDB** OPTION: C

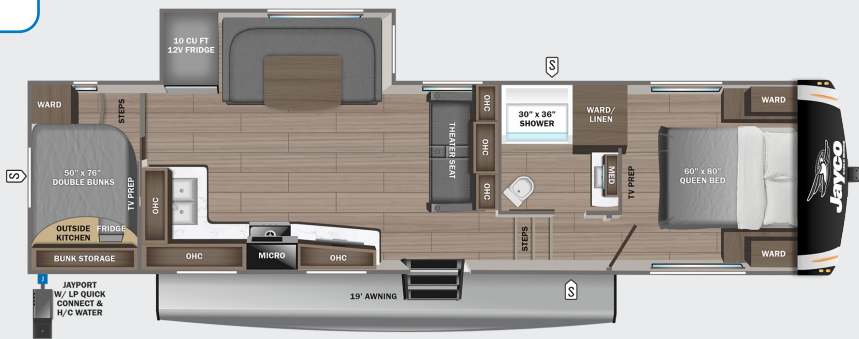

**29RLC** OPTIONS: A, B, C



# STANDARDS & OPTIONS

## EXTERIOR

1.5 in fresh water drain valve  
 5 in. Magnum Truss™ Roof System with limited lifetime warranty  
 50-amp detachable power cord  
 Auto-grade vinyl graphics  
 Automotive style painted front cap with max turn radius  
 Black tank flush  
 Climate Shield™ zero-degree tested weather protection:  
 - Fully enclosed and heated underbelly (ducted)  
 - 35,000 BTU furnace  
 - Double layer fiberglass batt insulation in ceiling and floor  
 - Double sided radiant barrier insulation (roof, floor and behind cap)  
 - PEX plumbing  
 Commercial grade rubber flooring in pass through area  
 Digital TV antenna with WiFi prep  
 Dual 30 lb. LP bottles  
 Dual channel exterior speaker  
 Factory installed roof ladder  
 Galvalume steel coated outside kitchens  
 HELIX Cooling System™ (industry exclusive):  
 - Jayco exclusive insulated dual duct design  
 - Directional and closeable A/C vents  
 - Larger return air vents with user accessible filters  
 Independent satellite and cable hookups  
 LED exterior lighting package  
 LP quick connect for gas griddle (next to JayPort)  
 Metal slam latch baggage doors  
 Nautilus 2.5 water connections  
 Nitrogen filled undermount spare tire (15 in.)  
 Quick connect water connections (door side hot/cold and off door side cold only)  
 Slide topper/awning prep  
 Stronghold VBL™ walls (laminated sidewalls, rear walls and slide out walls)

## INTERIOR

2 piece high gloss bathroom surround  
 5/8 in. tongue-and-groove plywood flooring  
 75 lb. full extension drawer guides  
 Bathroom skylight  
 Bedroom TV prep

C.P.A.P. prepped bedroom  
 Extra 120V power outlets in kitchen and slide rooms (where applicable)  
 Gas strutted under bed storage  
 Handcrafted and glazed door/drawer fronts (new sizes)  
 Inverter pre-wire (multiple locations) ((7) 110 outlets (4 USB's 12V)  
 Matte black kitchen faucet with pull-out sprayer  
 Porcelain foot flush toilet  
 Residential vinyl flooring throughout  
 Solid hardwood slide fascia  
 Stainless steel kitchen sink  
 Theater seating (select models)  
 Tri-fold hide-a-bed sofa with residential memory foam sleep surface (select models)  
 USB charging ports (multiple locations throughout)

## CUSTOMER VALUE PACKAGE (MANDATORY)

15K BTU "Whisper Quiet" A/C and bedroom A/C prep  
 4K Ultra LED HD Smart TV in living room (39 in.)  
 50-amp service with dual A/C ducts  
 60K on-demand water heater with mixing tank  
 Custom machined aluminum rims  
 Electric patio awning with integrated LED lights  
 GE black and stainless 17 in. range with edge to edge grates  
 GE microwave  
 Hidden hinges on cabinet doors  
 Keyed-Alike™ lock system  
 Rain proof bathroom power vent  
 Rear 2 in. towing receiver (4-pin connector on fifth wheels only)  
 Security monitor prep (rear)  
 Upgraded friction hinge entrance door

## LUXURY PACKAGE (MANDATORY)

Blackout roller shades with reflective side throughout  
 Electric auto-leveling  
 GE 10 cu.ft. 12V refrigerator  
 JayPort 2 in. mount (for outside accessories)  
 Residential style glass shower door  
 XL grab handle

## 4-STAR HANDLING PACKAGE (MANDATORY)

Dexter® Axles with NEV-R-Adjust® brakes and E-Z Lube® hubs  
 Goodyear® Endurance® tires (load range E)  
 MORryde® CRE-3000™ rubberized suspension  
 Wet bolt fasteners with bronze bushings

## OPTIONS

15K bedroom A/C  
 22 in. outside griddle with deep sink attachment for JayPort system  
 Booth dinette (select models)  
 Free standing table with leaf and bench seat  
 LED fireplace with 5,000 BTU electric space heater (select models)  
 Overlander 1 Solar Package: (1) 200W panels, MPPT 30-amp solar controller  
 Residential 60 in. x 80 in. queen size mattress  
 Theater seating in place of tri-fold sofa (select models)

\*Indicates split tanks

FLOORPLAN	TOTAL EXTERIOR LENGTH	EXTERIOR WIDTH	EXTERIOR HEIGHT (WITH A/C)	INTERIOR HEIGHT (MAIN)	INTERIOR HEIGHT (UPPER DECK)	UNLOADED VEHICLE WEIGHT	DRY HITCH WEIGHT	GVWR	CARGO CARRYING CAPACITY	FRESH WATER CAPACITY	GRAY WASTE WATER CAPACITY	BLACK WASTE WATER CAPACITY	SLEEPING CAPACITY
25RUC	29' 5"	8' 1"	12' 5"	8' 5"	6' 3"	8,010	1,610	9,500	1,490	52	82*	45	3-5
26REC	29' 5"	8' 1"	13' 0"	8' 5"	6' 3"	8,055	1,615	9,750	1,695	52	82*	45	1-2
29DDB	34' 7"	8' 1"	12' 11"	8' 5"	6' 3"	9,040	1,715	10,175	1,710	52	82*	45	5-7
29RLC	34' 1"	8' 1"	12' 6"	8' 5"	6' 3"	9,205	1,690	10,750	1,545	52	82*	45	3-4

Meet your Jayco Dealer



Scan QR code for specification definitions

Some specs at the time of print may include estimates. For the most updated information, please visit [Jayco.com](http://Jayco.com)

Jayco, Inc. | P.O. Box 460 | Middlebury, IN 46540

See dealer for further information and prices. All information in this brochure and on [www.jayco.com](http://www.jayco.com) is the latest available at the time of publication approval. Jayco reserves the right to make changes and to discontinue models without notice or obligation. Photography may show optional equipment or props used for decoration purposes only. RVs built for sale in Canada may differ to conform to Canadian codes. JAYCO and the JAYCO BIRD IN FLIGHT are registered trademarks of Jayco, Inc. Printed in USA 10/23 ©2023 Jayco, Inc.



Jayco - Part of Jayco Family of Companies